

FORMAX®

HERE BEGINS YOUR ULTIMATE VALUE

S+M Series
Three-phase Single
Hopper Loader

S12+M5



Please read the brochure carefully before operation.

S+M Series Three-phase Single Hopper Loader

■ Coding Principle

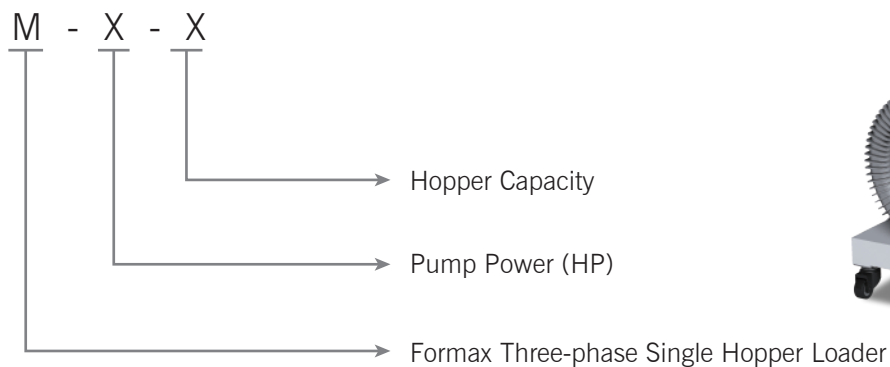

■ Features

- Adopt microprocessor and memory meter EPROM to save data permanently.
- LCD monitor, auto-cleaning function, and self-detected pump overload protection.
- It consists of cyclone duct collector and a dust collective bin to effectively reduce the load of filter.
- Wire connection point for FPV.
- Alarm light is as standard.
- M5 and models above equipped with vacuum breaking valve to protect the pump.

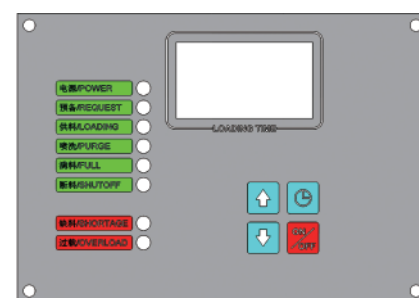

■ Application

M series three-phase single hopper loader collocated with stainless steel hopper to ensure no material containmination. Adopt high pressure pump which is durable, powerful, and long life.

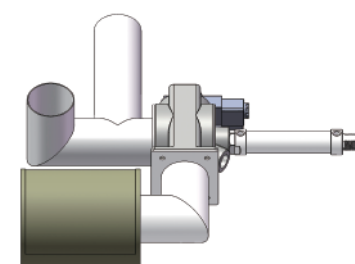

■ Options

The airflow with dust is rotating in high speed in the cyclone dust collector, under the function of centrifugal force, the dust is gathered upon the inner wall of the cyclone dust collector, and then upon the function of gravity, the dust finally falls down and comes out through the discharging hole. Rotated airflow is shrinkage to centre of hopper and then becoming secondary vortex flows out. It's effective to filter dust from hopper dryer and avoid of air pollution. The effect is up to 80%.

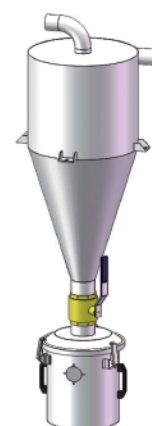

■ Loading Capacity

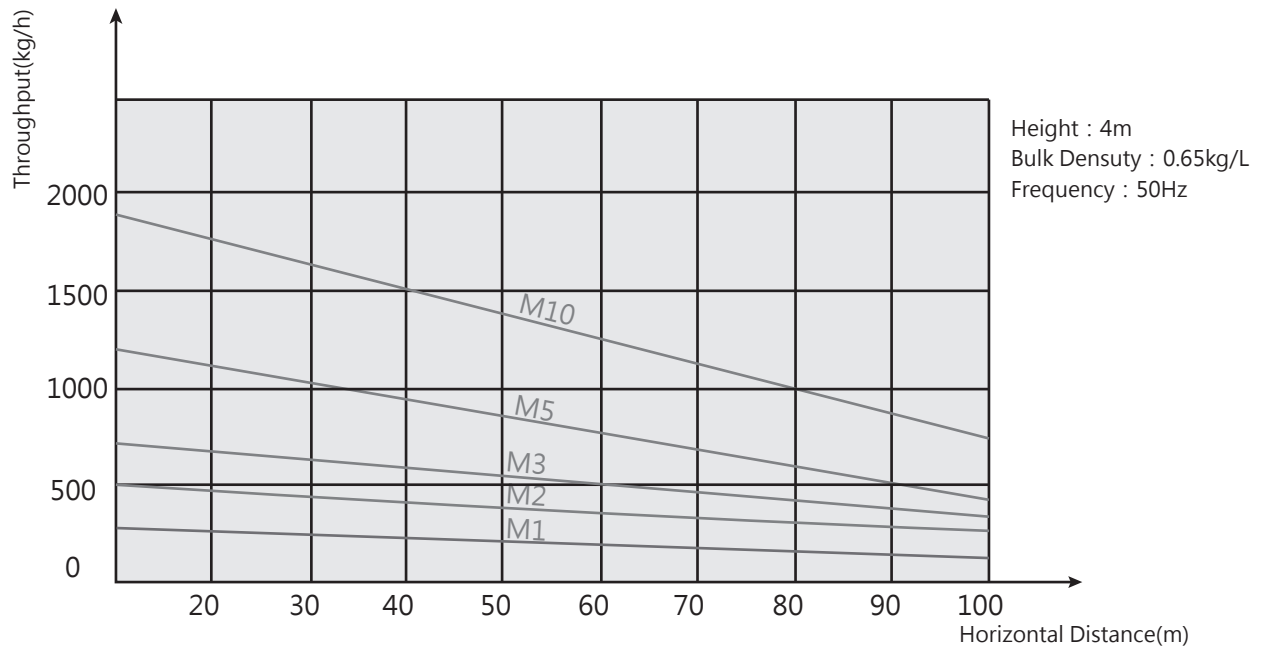

■ Outline Drawings

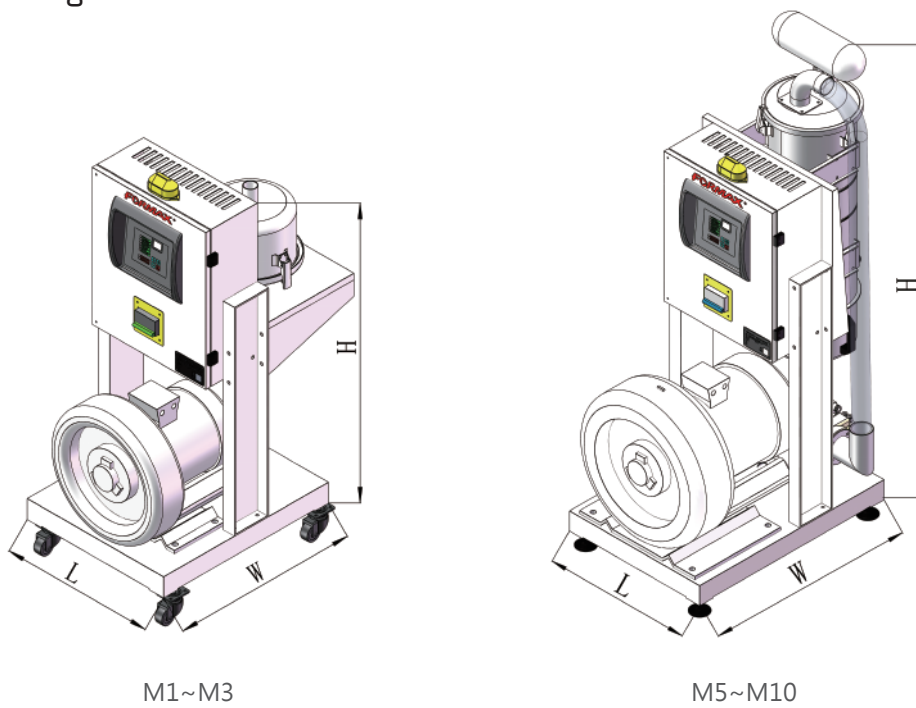

■ Specifications

Model		M1	M2	M3	M5	M10	M5D	M10D	
Pump Power	kW	0.75	1.5	2.2	4	7.5	4	7.5	
Material Pipe	inch	1.5/2	1.5/2	1.5/2/2.5	1.5/2/2.5	2/2.5/3	1.5/2/2.5	2/2.5/3	
Vacuum Pipe	inch	1.5/2	1.5/2	1.5/2/2.5	1.5/2/2.5	2/2.5/3	1.5/2/2.5	2/2.5/3	
Type		Single					Double		
Throughput	Kg/hr	250	400	500	750	1000	1000	1200	
Hopper Capacity	Ltr	3/6	6/12	6/12/24	12/24/36	24/36/48	12/24/36	24/36/48	
Voltage	V	3°C · 380VAC · 50Hz							
Accessory	Safety Filter	Standard			F12				
	Cyclone Dust Collector	Option			N/A				
	Vacuum Breaking Valve	N/A			Standard				
Dimension									
L	MM	480	480	580	680	680	680	680	
W		680	820	480	480	480	480	480	
H		1100	1400	1100	1330	1330	1330	1330	
Net Weight	Kg	28	38	53	56	102	56	102	

Note: 1) Test condition of throughput: plastic material of bulk density 0.65kg/L,
vertical conveying height 4m, horizontal conveying distance 5m.

Specifications are subject to change without prior notice.

FORMAX®

China
Formax Plastics Automation, Inc.

Dongguan
Xianxi New Industrial Zone, Xianxi Community,
Changan Town, Dongguan, Guangdong, China
Tel. +86-769-3899-9898 Fax. +86-769-8533-3467

Kushan
No.138-20, Hengshan Road, Kunshan, Jiangsu, China
Tel. +86-512-5700-8308 Fax. +86-512-5700-8306

Taiwan
Formax Equipment Inc.

7F-1, No.265, Nankang Road, Luchu Dist.,
Taoyuan City, Taiwan
Tel. +886-3-2121-725 Fax. +886-3-2127-960

www.formax88.com
www.formaxpa.com



All rights reserved.